

SCREW TYPE 1 PIECE BALL VALVE (REDUCER BORE)



ACTUATOR : DOUBLE ACTING

BODY PRESS : MAX 10kgf/cm²

TEMP : MAX 80°C(P.T.F.E)

AIR PRESSURE : 4~7kgf/cm²

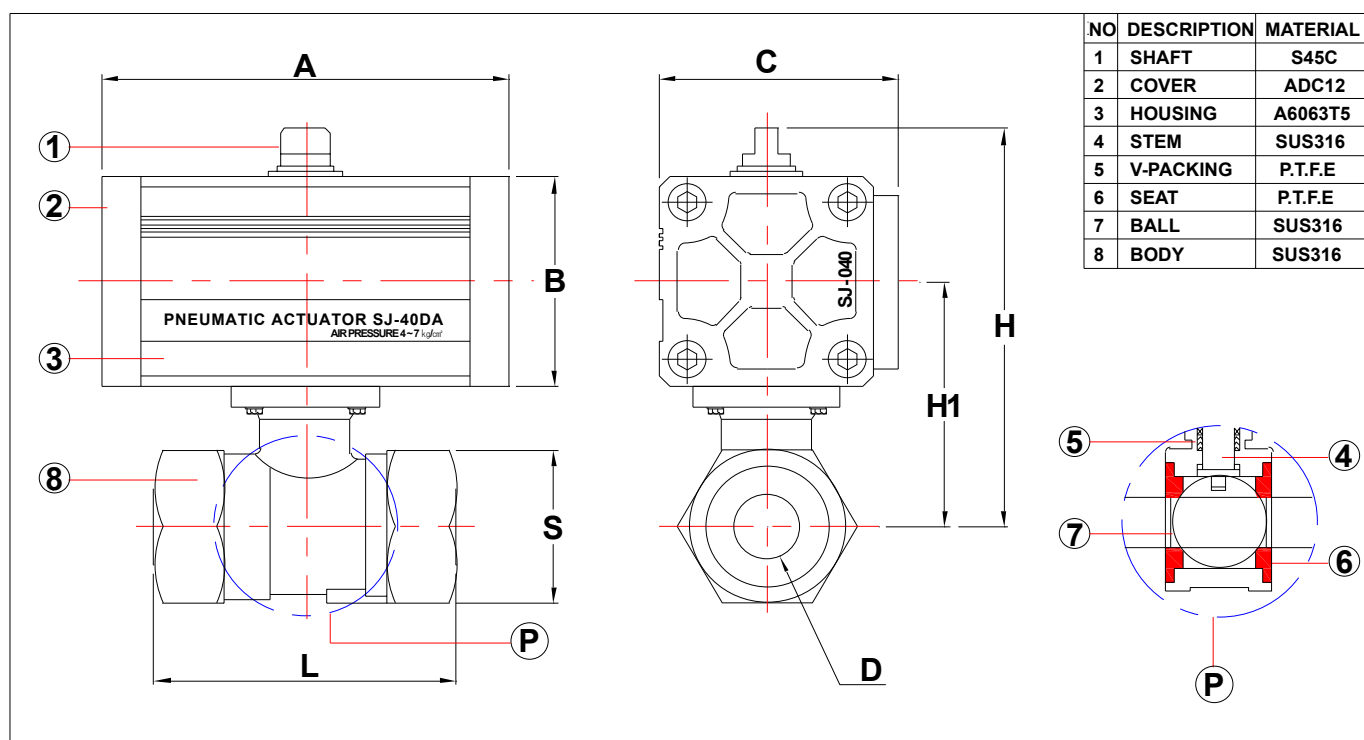

DIMENSION

UNIT : mm

| VALVE SIZE | | ACTUATOR | A | B | C | D | L | S | H1 | H |
|------------|-----|----------|-----|----|----|------|------|----|------|-------|
| 1/2" | 15A | SJ-40DA | 99 | 52 | 58 | 9.2 | 50 | 25 | 52.5 | 90.5 |
| 3/4" | 20A | SJ-40DA | 99 | 52 | 58 | 12.5 | 60 | 32 | 54.5 | 92.5 |
| 1" | 25A | SJ-40DA | 99 | 52 | 58 | 16 | 73.5 | 38 | 59 | 97 |
| 1-1/4" | 32A | SJ-50DA | 122 | 67 | 68 | 20 | 78 | 49 | 77.5 | 129.5 |
| 1-1/2" | 40A | SJ-50DA | 122 | 67 | 68 | 24.5 | 90 | 53 | 82.5 | 134.5 |
| 2" | 50A | SJ-50DA | 122 | 67 | 68 | 32 | 100 | 65 | 89 | 141 |